

Booster Tank 100 & 200

The Booster Tank is a safe and reliable water reservoir and pump solution which is used to provide sufficient water flow and pressure to operate flush manifolds, solid dissolver systems, or any other dispensing system where low water flow and/or low water pressure are a concern. The reservoir automatically fills until it reaches 4 gallons and then will automatically shut off. The diaphragm pump will provide consistent, steady water flow and water pressure to dispenser systems.

This package should contain:



- Tank
P/N 10097124



- Pump (115VAC)
P/N 10097109 1.1 GPM
P/N 10097125 2.0 GPM



- Pick up assembly
P/N 10097128



- Valve assembly
P/N 10097127



- Float assembly
P/N 5043-A



- Accessory kit
P/N 10097126



Please use this equipment carefully and observe all warnings and cautions.

ALWAYS observe safety and handling instructions of the chemical manufacturers.

ALWAYS direct discharge away from you or other persons or into approved containers.

ALWAYS dispense cleaners and chemicals in accordance with manufacturer's instructions. Exercise CAUTION when maintaining your equipment.

KEEP equipment clean for proper operation.

WEAR protective clothing and eyewear when working in the vicinity of all chemicals, filling or emptying equipment, or changing tubes.

ALWAYS re-assemble equipment according to instruction procedures. Be sure all components are firmly screwed or latched into position. Ensure that hoses and electrical wires are properly placed and not kinked or pinched.

ALWAYS connect probes before powering on the unit.

Booster Tank 100 & 200 Unit Specifications*:

Size	19"H x 18"W x 14"D
Dry Weight	17.64 lbs
Power Rating	115VAC 50/60hz
Temperature	10 to 60 C (50 To 140 F) maximum
Humidity	85% relative humidity, maximum
Indoor Installation	Approved for indoor use only. Must not be installed outdoors.
Altitude	Install at or below 8,000 ft.

*Specifications subject to change without notice

Additional Support:

<http://www.hydrosystemsco.com>

This guide contains instructions for installing, operating, maintaining, and troubleshooting the Booster Tank.

Installation

STEP 1 : Install water pickup tube

- a. Route open end of pickup tube assembly through hole in lid of reservoir.
See picture at right.



STEP 2 : Install pump

- a. Use screwdriver to mount pump to lid of the reservoir with (4) screws provided.
- b. Align pump as shown in picture.



STEP 3 : Connect pickup tube to pump

- a. Slide clamp over end of pickup tube.
- b. Slide tube over inlet barb of pump.
- c. Tighten hose clamp to secure pickup tube.



STEP 4 : Install water valve assembly

- a. Install hose barb into elbow on water valve.
- b. Use screwdriver to mount the water valve assembly to the lid of the reservoir with (2) screws provided.
- c. Align water valve assembly as shown in picture.

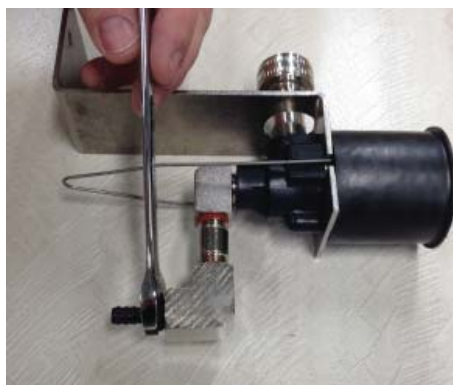

Installation (continued)

STEP 5 : Install s-hook on float

- Slide one end of S-hook into loop on the top of the float.



STEP 6 : Install other end of s-hook

- Guide other end of S-hook through hole in reservoir.
- Hook end of S-hook around yoke of water valve assembly.



STEP 7 : Connect water supply inlet hose

- Install water supply hose to the female garden hose fitting on the inlet of the water valve assembly as shown.
- Make sure connection is tight.



STEP 8 : Connect water outlet tube

- Connect 1/2"ID tube to outlet barb of pump.
- The tubing from the pump outlet should be connected to the unit (solid dissolver or flush manifold) the Booster Tank will be supplying water for.



STEP 9 : Turn on water supply to Booster Tank

- Turn on water supply to fill Booster Tank reservoir.
- When tank is full the float will rise and the water valve will shut off.

STEP 10 : Turn on water supply to Booster Tank

- Plug power cord of pump into 115VAC outlet to provide water from Booster Tank to desired destination (solid dissolver or flush manifold).

NOTE: The pump will shut off when it encounters 60 psi of back pressure.

Booster Tank Parts list and Diagram:

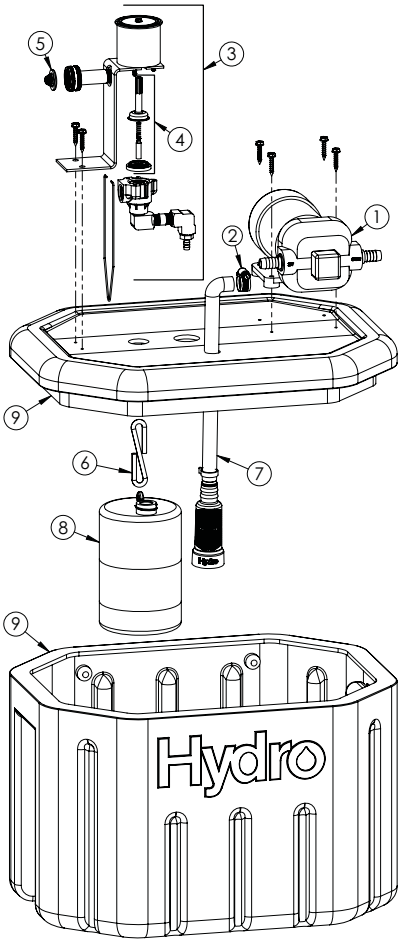

Key	Part Number	Description
1	10097109	Pump, 1.1 GPM
	10097125	Pump 2.0 GPM
2	608200	Hose clamp
3	10097127	Kit, Hydrominder valve assembly
4	665520	Valve parts kit, plastic bonnet
5	238100	Strainer washer
6	10092551	S-hook
7	10097128	Kit, Pickup tube
8	5043-A	Float assembly
9	10097124	Booster Tank reservoir with lid

Booster Tank 100 & 200 Troubleshooting

ISSUE

Tank not filling

Pump will not run

CAUSE

Clogged inlet washer

Float failed to turn on water valve

Pump not plugged in or no AC power

Footvalve strainer clogged

SOLUTION

Clean or replace inlet washer

Replace float

Plug in pump or restore AC power

Clean or replace Footvalve strainer



3798 Round Bottom Road
Cincinnati, Ohio 45244
(513) 271-8800
(800) 543-7184
Fax: (513) 271-0160
Website: <http://www.hydrosystemsco.com>